

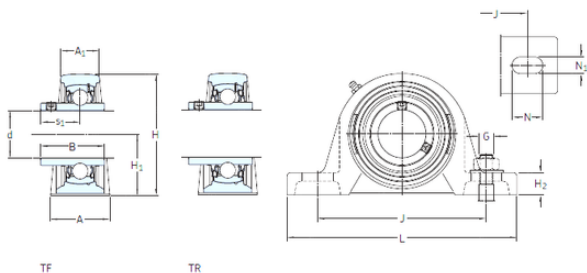

NTN Bearing Driveshaft do Brasil



SKF SY 1.5/8 TF bearing units

Bearing No. SY 1.5/8 TF

SY 1.5/8 TF Bearing 2D drawings and 3D CAD models

Bore Diameter	41,275 mm
d	41,275 mm
s1	30,2 mm
A	48,3 mm
A1	32 mm
B	49,2 mm
G	12 mm
H	107 mm
H1	54 mm
H2	20,6 mm
J	143,7 mm
L	187 mm
N	22,7 mm
N1	14 mm
Weight	2,45 Kg
Basic dynamic load rating (C)	33,2 kN
Basic static load rating (C0)	21,6 kN
Fatigue load limit (Pu)	0,915
Category	Pillow Block Bearings
Inventory	0.0
Manufacturer Name	SKF
Minimum Buy Quantity	N/A
Weight / Kilogram	2.45
EAN	7316577755636
Product Group	M06110
Number of Mounting Holes	2



NTN Bearing Driveshaft do Brasil

Mounting Method	Set Screw
Housing Style	2 Bolt Pillow Block
Rolling Element	Ball Bearing
Housing Material	Cast Iron
Expansion / Non-expansion	Non-expansion
Mounting Bolts	1/2 Inch
Relubricatable	Yes
Insert Part Number	YAR 209-110-2F
Seals	M Seal
Housing Configuration	1 Piece Solid
Inch - Metric	Inch
Other Features	Single Row Standard Duty Wide Inner Race Y Bearing Has Flinger
Long Description	2 Bolt Pillow Block; 1-5/8" Bore; 2-1/8" Base to Center Height; Set Screw Mount; Ball Bearing; 5-5/16" Minimum Bolt Spacing; 6" Bolt Spacing Maximum; Relubricatable; Cast Iron; M S
Category	Pillow Block
UNSPSC	31171511
Harmonized Tariff Code	8483.20.40.40
Noun	Bearing
Keyword String	Pillow Block
Manufacturer URL	http://www.skf.com
Manufacturer Item Number	SY 1.5/8 TF
Weight / LBS	5.4
Bore	1.625 Inch 41.275 Millimeter
Actual Bolt Center to Center	0 Inch 0Millimeter
Length Thru Bore	1.938 Inch 49.225 Millimeter



NTN Bearing Driveshaft do Brasil

Nominal Bolt Center to Center	5.8 Inch 146.5 Millimeter
Base to Center Height	2.125 Inch 53.98 Millimeter
Bolt Spacing Minimum	5.313 Inch 134.95 Millimeter
Bolt Spacing Maximum	6 Inch 152.4 Millimeter
Housing material	Cast iron
A ₁	32 mm
A ₅	26.5 mm
B ₄	8 mm
H ₁	54 mm
H ₂	21 mm
J max.	152 mm
J min.	135 mm
N ₁	14 mm
s ₁	30.2 mm
R _G	1/4-28 UNF
R ₁	4 mm
R	45 °
D _N	6.5 mm
SW _N	7 mm
G _N	1/4-28 SAE-LT
J ₆	173 mm
J ₇	17 mm
N ₄	4 mm
Basic dynamic load rating C	33.2 kN
Basic static load rating C ₀	21.6 kN
Fatigue load limit P _u	0.915 kN
Limiting speed	4300 r/min
Mass bearing unit	2.25 kg
Thread grub screw G ₂	5/16-24 UNF
Hexagonal key size for grub	3.969 mm



NTN Bearing Driveshaft do Brasil

screw N	
Recommended tightening torque for grub screw	6.5 N · m
Recommended diameter for attachment bolts, mm G	12 mm
Recommended diameter for attachment bolts, inch G	0.5 in
Housing	SY 509 M
Bearing	YAR 209-110-2F
End cover	ECY 209